

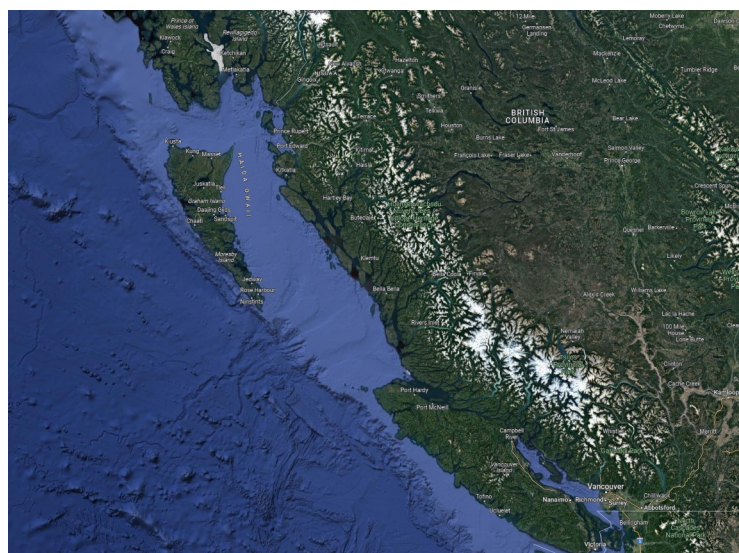

WHALES & WILD ISLES - BRITISH COLUMBIA CATAMARAN CRUISE

This epic summertime supervoyage along the remote north and central coast of the Great Bear Rainforest (BC, Canada) specializes in whales, far-flung islands and the oceanic world they inhabit. Step onto wild, white-sand beaches, spend hours with humpback whales and other marine mammals, visit the best place on earth to see orcas (killer whales), and visit with whale researchers who are making new discoveries from their station at the aptly named Whale Channel. Rainforest, other wildlife, and frequent shore trips round out this amazing journey through British Columbia's awesome natural and cultural history.



ITINERARY

Day 1: Prince Rupert

Welcome aboard, and island cruising watching for whales. Evening beach walk.

Day 2: Cruising

Morning kayak. Cruising up the outer coast, looking for oceanic birds and animals. Afternoon explore of offshore island group, both on land and by tender. Possible groups of humpbacks or fin whales.



Day 3: Cruising

Morning kayak. Marine mammal viewing. Afternoon beach + bog gentle hike to view and beach activities. Evening beach fire.

Day 4: Cruising

Baleen whale and other marine mammal viewing. Visit sea lion haul out. Visit whale research station for personal tour and discussion with Cetacealab or Fin Island whale researchers' groundbreaking work in the region. Evening forest walk.

Day 5: Cruising

Cruising a majestic mainland fjord. Visit natural hot springs. Summer river estuary visit.

Day 6: Cruising

Cruising deeper into the fjords, exploring waterfalls and ashore as we go, until we reach the great Kitlope river valley and estuary at the foot of 4,000-foot mountains for our night's anchorage.

Day 7: Cruising

Exploring other regions in this fjord, second (different) hot springs visit. Marine mammal viewing. Evening zodiac tour or

walk.

Day 8: Cruising

Visit village of Hartley Bay for cultural tour. Cruising northward among the inlets and waterways, as always watching for wildlife. Explore marine park and rainforest walk.

Day 9: Prince Rupert

Morning shore trip or kayak. Cruising to port.

Please Note:

There are 2 routes for this trip, within the same overall region. Both feature similar highlights. As with all expedition cruises, the itinerary may change based on weather, wildlife activity, and interests of the guests. This itinerary is to give you a general idea of the trip.



The Small Cruise Ship Collection

www.small-cruise-ships.com

small-cruise-ships.com

info@small-cruise-ships.com

YOUR SHIP: CASCADIA

YOUR SHIP: Cascadia

VESSEL TYPE:

LENGTH:

PASSENGER CAPACITY:

BUILT/REFURBISHED:

Cascadia is a go-anywhere, expedition style catamaran. She accommodates up to 24 guests in 12 luxurious cabins, with a crew of 10. She is unlike any other vessel offering expeditions on the British Columbia coast, having been built specifically for high-quality, boutique cruises. Light, spacious and comfortable, she is also capable of reaching the wildest, most naturally rich places on the coast. Her small size and guest numbers provide an authentic, human-scale experience that respects the carrying capacity of coastal inlets and communities. Ship And Accommodations Find comfort and solitude in your private cabin or enjoy time in any of the interior or outdoor lounges, or the "open" bridge. Cascadia's large windows bring the outside in, and her separate dining area becomes a sophisticated "long table" event for meals. Her decks are wide and welcoming, with seating areas on different levels. Salon Large windows surround the salon making it a perfect place to look for whales while staying protected, chat with other guests while lounging on our comfortable sofas, or enjoy a beverage from the nearby bar. Dining Area Enjoy our chefs' fine west-coast influenced creations while watching the sun go down. Sit and discuss your day's adventure with your captain, afloat in a remote natural

anchorage. Terrace Lounge And Dining Area Dine alfresco on temperate evenings, lounge with your morning coffee, or watch the world go by during the day. This area is the perfect mix of outside and inside. Bridge of Cascadia Cascadia's bridge is open to you. You'll have 180-degree views from here, along with being able to learn about navigation and the vessel systems from our crew. On the port side, you may also enjoy our indoor-outdoor loveseat. You can watch the world go by from behind a protective window, but still have quick access to the fresh air and the deck for whale watching. Top Deck & Hot Tub Lounge on a chaise, soak under the stars, or enjoy the bird's eye view of the ship and the world around her from Cascadia's new top deck. Cabins All cabins have individual climate control, wardrobes and an outside location, with windows for natural light. All have ensuite. All are 'outside' cabins, with windows for natural light. Kayaks, Shore Boats, Naturalist Tools Cascadia has 6 double and 2 single kayaks for paddling in coves and bays, as well as two beautiful landing craft style tenders, custom designed for our program. She carries a suite of tools for exploring the natural world, including a hydrophone for listening to whales. Her library contains books on the cultural history and nature of the BC and

The Small Cruise Ship Collection
www.small-cruise-ships.com

01432 507 280 (within UK)

info@small-cruise-ships.com | small-cruise-ships.com



Alaska coast.



The Small Cruise Ship Collection

www.small-cruise-ships.com



small-cruise-ships.com

info@small-cruise-ships.com

INSIDE YOUR SHIP

TOP DECK

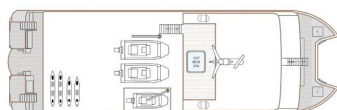

BRIDGE DECK

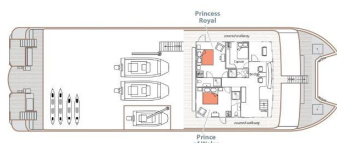

MAIN DECK



LOWER DECK



The Small Cruise Ship Collection

www.small-cruise-ships.com

01432 507 280 (within UK)

info@small-cruise-ships.com | small-cruise-ships.com



The Small Cruise
Ship Collection

www.small-cruise-ships.com



small-cruise-ships.com

info@small-cruise-ships.com

PRICING



The Small Cruise
Ship Collection

www.small-cruise-ships.com

01432 507 280 (within UK)

info@small-cruise-ships.com | small-cruise-ships.com