

The Small Cruise Ship Collection

www.small-cruise-ships.com

small-cruise-ships.com

info@small-cruise-ships.com

SUPREME SPLIT RETURN (ADRIATIC QUEEN)

MS Adriatic is a deluxe and stylish vessel, a perfect way to sample the spectacular Adriatic Coastline. Enjoy modern spacious cabins with private facilities and air conditioning. Relax and enjoy the sundeck lounge chairs and Jacuzzi!



ITINERARY

Day 1 SPLIT ARRIVAL, Wednesday

You will be transferred from Split's airport or your Split hotel to harbour, where embarkation begins at 13:00h. Get settled in your cabin before attending a Welcome Reception followed by dinner this evening.

Day 2 SPLIT - STARI GRAD, Thursday

Morning sail towards Stari Grad, swimming stop and lunch on board. Stari Grad is one of the oldest towns in Europe with many friendly and cheap konobas and restaurants in the backstreets of the old town. The Stari Grad Plain and the old town centre of Stari Grad have been listed as UNESCO World Heritage Sites since 2008. Your evening is free to explore Stari Grad on your own.

Day 3 STARI GRAD - HVAR - KOR ULA (Wine tasting) , Friday

Morning departure towards Hvar, the most popular island in the Adriatic and a meeting point for the international jet set. A



The Small Cruise Ship Collection

www.small-cruise-ships.com

small-cruise-ships.com

info@small-cruise-ships.com

sightseeing tour of this charming town, with 8 centuries of architecture, will show you the picturesque little streets and the first public theatre in Europe (older than Shakespeare's theatre in the UK). Afterwards we set sail for Korula, with swimming stop in one of pristine bays and lunch onboard. Early afternoon arrival to Korula, thought to be the birthplace of the famous explorer Marco Polo. Take a walking tour through this fortified town which is one of the best preserved medieval cities in the Mediterranean and enjoy wine tasting in one of the local wine bars. Your evening is free to discover the town and enjoy dinner on your own at one of the many good restaurants.

Day 4 KORULA - DUBROVNIK, Saturday

In the morning sail to Dubrovnik, the "Pearl of the Adriatic", a UNESCO World Heritage site. Upon arrival in Dubrovnik, you will enjoy a guided tour of the magnificent Old Town with a panoramic bus ride above the Old Town. After the panoramic view, we will arrive at the historical centre of Dubrovnik, walk through STRADUN - both a street and a square, the most famous place inside the town walls, the famous city enlisted as UNESCO's World Heritage site, where your guide will show you the most interesting sights of Dubrovnik. After city tour, you will be left on your own to explore the city, visit City Walls, the Franciscan Monastery with Europe's second oldest pharmacy, the Rector's Palace and the Cathedral, take a boat ride to Lokrum island or take the cable car to the top of the Mount Sr. Overnight in Dubrovnik

Day 5 DUBROVNIK - MIJET, Sunday

Today we turn our compass back north towards Mljet Island, with plenty of time for morning swim along the sail. Upon arrival join the Cruise Manager for a visit to the famous salt lakes in the National Park and enjoy the boat ride to St. Mary Isle to visit an

ancient Benedictine monastery, an old abbey and a Church dating back to the 12th Century. Mljet National Park encompasses five types of forest, many species of birds, and two deep lakes, Veliko Jezero (Big Lake) and Malo Jezero (Small Lake). Your evening is free in Mljet.

Day 6 MIJET - PUŠĆA, Monday

Take a break for a swim during your morning cruise. Continue sailing through lunch, arriving this afternoon in Pušća, a beautiful little town on island of Brač. Pušća, village of the stone sculpture, where you can visit amazing stonemason school (optional), features a spectacular steep-sided natural harbour and authentic Mediterranean architecture. Tonight enjoy Captain's dinner onboard.

Day 7 PUŠĆA - OMIŠ - SPLIT, Tuesday

Next we head to our final port Omiš with its fortresses which are silent stone reminders of the power of the pirates who once made their homes and fortunes here. You will have a possibility to book a short walking tour, followed by boarding a small boat and sail into Cetina River Canyon, a protected nature area, continuing to Radman Mills for a local specialty snack (optional). After visiting Omiš set sail to Split with a stop along the way to swim, cool off and relax, if weather permits, with lunch onboard. In the late afternoon we arrive in Split to take a guided tour of the historical center of city which is listed as a UNESCO World Heritage site. Your evening is free in Split.

Day 8 SPLIT DEPARTURE, Wednesday

After breakfast it's time to disembark. You will be transferred to Split airport or your Split hotel

Please note:

The Small Cruise
Ship Collection

www.small-cruise-ships.com

01432 507 280 (within UK)

info@small-cruise-ships.com | small-cruise-ships.com



The Small Cruise Ship Collection

www.small-cruise-ships.com



small-cruise-ships.com

info@small-cruise-ships.com

Itineraries are subject to change.



The Small Cruise Ship Collection

www.small-cruise-ships.com

01432 507 280 (within UK)

info@small-cruise-ships.com | small-cruise-ships.com

The Small Cruise Ship Collection

www.small-cruise-ships.com

small-cruise-ships.com

info@small-cruise-ships.com

YOUR SHIP: ADRIATIC QUEEN(CATAMARAN)

YOUR SHIP: Adriatic Queen(Catamaran)

VESSEL TYPE: Small Ship

LENGTH: 35 meters

PASSENGER CAPACITY: 30

BUILT/REFURBISHED:



This luxurious vessel was completely renovated in 2017 with latest state-of-the-art equipment and amenities. It is 115 ft long, 36 ft wide, with cruising speed of 10 NM. Maximum capacity is 30 passengers in 15 cabins, all on one deck, all fully air-conditioned, with queen-size (7) or twin beds (8), cupboard, cabinet and window or porthole, bathroom with shower, toilette and wash basin. Cabin size varies between 140 sq ft and 172 sq ft. There is free wireless internet access (Wi-Fi). The ship features fully air-conditioned salon-restaurant with bar and LCD TV. Large lounging sun deck has a jacuzzi fitting up to 6 people, and provides sun-shade cover and deck-beds for all passengers. The ship has a rear access platform to the sea as well as ladders for easy access to the water. Ship Amenities: Sun deck, restaurant & bar, complimentary Wi-Fi. Cabins include: LCD TV, A/C, safe deposit box, fridge, sound-proofing, internal communication system with bar.

The Small Cruise Ship Collection
www.small-cruise-ships.com

01432 507 280 (within UK)

info@small-cruise-ships.com | small-cruise-ships.com

The Small Cruise Ship Collection

www.small-cruise-ships.com

small-cruise-ships.com

info@small-cruise-ships.com

INSIDE YOUR SHIP

SUN DECK

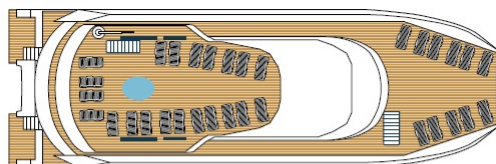

BRIDGE DECK

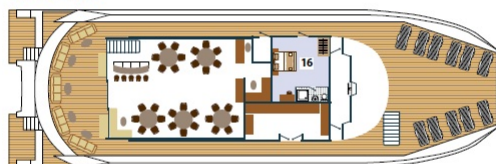

MAIN DECK





The Small Cruise
Ship Collection

www.small-cruise-ships.com



small-cruise-ships.com

info@small-cruise-ships.com

PRICING

ADDITIONAL CHARGES:

Port tax and tourist tax 35 EUR pp



The Small Cruise
Ship Collection

www.small-cruise-ships.com

01432 507 280 (within UK)

info@small-cruise-ships.com | small-cruise-ships.com