

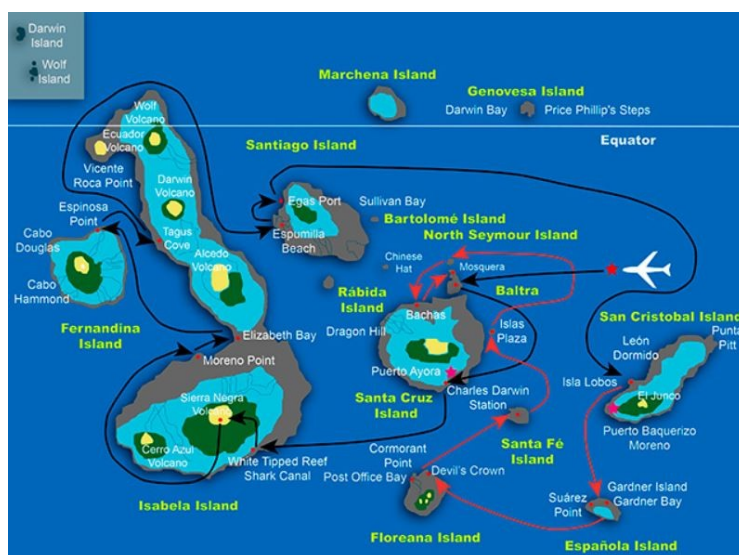

SEA STAR JOURNEY “C+A” ITINERARY

From the West to the South, a breathtaking exploration circling the most wonderful and life-filled sites sailing from Isabela and Fernandina visiting incredible locations like Sierra Negra Volcano, Espinoza Point, Elizabeth Bay and more. Then sail down the southern archipelago to encounter fantastic wildlife and snorkeling at Gardner Bay, Suarez Point and Cormorant Point. This itinerary will not be complete with visits to must-see Santa Fe, Plaza and North Seymour Islands before returning back to Mainland after enjoying a fantastic trip.



ITINERARY

DAY 1 – THURSDAY: BALTRA AIRPORT PM: CHARLES DARWIN STATION, SANTA CRUZ ISLAND

Sea Star Journey C+A itinerary: Upon arrival at Baltra Airport, travelers pass through an airport inspection point to insure that no foreign plants or animals get in into the islands, as well as to pay the park entrance fee of \$100 (unless it has been prepaid). A representative of our Galapagos Sea Star Journey I, will meet you, help you collect your luggage, and escort you bus ride to Puerto Ayora Village and then embark on board our yacht PM: CHARLES DARWIN STATION, SANTA CRUZ ISLAND Although the great majority of Galapagos visitors come here to observe and appreciate natural wonders, you can also learn how is managed the protection and conservation of the islands. The main attractions are the National Park information center, the Van



The Small Cruise Ship Collection

www.small-cruise-ships.com

small-cruise-ships.com

info@small-cruise-ships.com

Staelen Exhibition Hall, the Breeding and Rearing Center for young tortoises and adult Galapagos tortoises in captivity.

DAY 2 – FRIDAY AM: WHITE TIPPED REEF SHARK CANAL, ISABELA ISLAND PM: SIERRA NEGRA VOLCANO, ISABELA ISLAND

AM: WHITE TIPPED REEF SHARK CANAL, ISABELA ISLAND A delightful place reached by a nice zodiac ride. “Tintoreras” are small islands in front of Puerto Villamil coast. There is Heron lava on the lookout on mangrove branch, and Galapagos Penguin and sea lion often pop out on shore. White-tipped reef sharks are fairly common in the archipelago. Their name in Spanish is Tintorera, in fact, this is the name of the site as well. They are always here resting in the shallow waters. **PM: SIERRA NEGRA VOLCANO, ISABELA ISLAND** Isabela Island is the largest and one of the youngest islands in the Galapagos archipelago. We land in Puerto Villamil, which has the second smallest population in Galapagos with approximately 3000 hab. We head up to the highlands from Puerto Villamil to Sierra Negra slope, and later we will do some hiking on uneven terrain until we arrive to the Sierra Negra volcano rim. Sierra Negra is the second widest crater in the world. From this viewpoint, you have fantastic sights to the 6 x 5 -mile-wide crater, the rest of the volcanoes, and Perry Isthmus, a 12 Km wide lava field. From here we can hike to Chico Volcano to watch the striking lava formations, examples of the geological occurrences that have created the Galapagos Islands.

DAY 3 – SATURDAY AM: PUNTA MORENO, ISABELA ISLAND PM: ELIZABETH BAY, ISABELA ISLAND

AM: PUNTA MORENO, ISABELA ISLAND Punta Moreno is located on the north coast of Isabela Island between the volcano Sierra Negra and Cerro Azul volcano. The trail runs along a lava flow Pahohoe (solidified lava in the form of corrugated or an

accordion) into a complex of coastal lagoons, its main attraction are several species of birds which can be found around this lakes and mangroves tours to isabela island **PM: ELIZABETH BAY, ISABELA ISLAND** This is a marine visitor site, the excursion is carried out in a zodiac and so there is no landing point. Your zodiac ride starts with a visit to the Marielas islets. Here there is the largest and most important penguin colony in the Galapagos Islands. The excursion continues into the cove and its red mangroves. There, you can admire their red roots and green leafs. It is here that you are able to observe sea turtles, flightless cormorants, spotted eagle rays, golden rays, brown pelicans and sea lions. Frequently visitors have been able to see Galapagos Hawks soaring overhead whilst schools of Pompano and Dorado fish swim below

DAY 4 – SUNDAY AM: PUNTA ESPINOZA, FERNANDINA ISLAND PM: TAGUS COVE, ISABELA ISLAND

AM: PUNTA ESPINOZA, FERNANDINA ISLAND Fernandina is the third largest island in the archipelago and has a single visitor site: Punta Espinoza located at the northeastern tip of the island. Just across Tagus Cove, you can see some of the unique species of Galapagos. Marine iguanas conglomerate in larger groups than in any other island. They bask around in the sand, swim near the shore and some time block the way at the landing dock. Among the unique species found here, is the Flightless Cormorant. A bird that due to the lack of predators, had to adjust their way of survival and improve their skills of finding food in the ocean. Their wings, tails and feet progressively adapted for swimming. To see these birds, is to witness evolution happening right in front of you. Stay within 2m of the cormorants and penguins. **PM: TAGUS COVE, ISABELA ISLAND** Tagus Cove, a tour along the cliffs in a zodiac will give the visitors a good chance to see the Galapagos penguin, the



The Small Cruise Ship Collection

www.small-cruise-ships.com

01432 507 280 (within UK)

info@small-cruise-ships.com | small-cruise-ships.com



The Small Cruise Ship Collection

www.small-cruise-ships.com



small-cruise-ships.com

info@small-cruise-ships.com

flightless cormorant and other sea birds. From the landing dock it is about a 30 minute hike along the trail up to the top of the cliff from where you can view Darwin Lake, an uplifted ultra-saline lake saltier than the sea. You can also see several volcanoes from this location. Look carefully at the graffiti on the surrounding cliffs of the cove; Pirates, whalers and buccaneers wrote them in past centuries.

DAY 5: MONDAY AM: ESPUMILLA BEACH, SANTIAGO ISLAND PM: PUERTO EGAS, SANTIAGO ISLAND

AM: ESPUMILLA BEACH, SANTIAGO ISLAND In northern coast of Santiago Island in James Bay, is Espumilla Beach. During the last presence the El Niño phenomenon, one of the two lagoons in this site, underwent a process of sedimentation, thus causing the disappearance of a representative colony of flamingos. The main attractions are the Palo Santo forest and the marvelous. The beach is an important site for nesting marine turtles. **PM: PUERTO EGAS, SANTIAGO ISLAND** Its black beach is located at the west side of the island and is the main attraction of the island. Their volcanic tuff deposits formed this special black sand beach. This site is called Puerto Egas, because there was an attempt of company of Hector Egas, to start the exploitation of salt, which failed because the price of salt in the continent was very cheap, and did not justify its exploitation in Galapagos. They abandoned the project and they left their infrastructure.

DAY 6 – TUESDAY AM: ISLA LOBOS, SAN CRISTOBAL PM: PUERTO CHINO AND BREEDING CENTER

AM: ISLA LOBOS, SAN CRISTOBAL This little island is reach at approx 1 hour by panga from Port Baquerizo Moreno, the capital of the Island. The trail will lead across a dry vegetation zone, substrate of volcanic rocks and sandy areas. There is a small population of blue-footed boobies and frigate birds, which nest

in this site. At the beach you will see a large colony of sea lions. It is common to see shorebirds. **PM: PUERTO CHINO AND BREEDING CENTER** In the afternoon, you will visit Puerto Chino. It is rife with huge cactus over the trail like trees. Once you get on the beach, you will enjoy its surroundings with it wildlife. Sea lions share the beach with people so its common see the puppies playing and swimming. Enjoy the deep blue waters with the waves and tide, occasionally there is wildlife to see, especially tortoises. After, you will visit the Breeding Center Jacinto Gordillo, also known as the “Galapaguera” is a good place to observe Galapagos tortoises in its natural habitat. San Cristobal island has endemic species such as: the Mockingbird *Nesomimus melanotis*, lava lizard (*Microlophus bivittatus*), Chatham Leaf-toed Gecko (*Phyllodactylus leei*) and the tortoises. All of these species can be observed in this place, the beach is really big and it works as a nesting zone for marine tortoises.

DAY 7 – WEDNESDAY AM: ESPAÑOLA ISLAND, GARDNER BAY PM: ESPAÑOLA ISLAND, PUNTA SUAREZ

AM: ESPAÑOLA ISLAND, GARDNER BAY Located on the north-eastern coast of Hood, Gardner Bay provides an excellent beach for relaxing, swimming, snorkeling, kayaking, and the opportunity to observe sea lions. Here we can also observe sharks in the crystal clear ocean waters. **PM: ESPAÑOLA ISLAND, PUNTA SUAREZ** This rocky land spot sustains one of the most impressive and varied colonies of sea birds in the Galapagos. Along its southern shore, high cliffs rise up from the sea affording the visitor spectacular views of soaring birds and of the blow whole where water spouts up to 50-75 feet into the air according to the intensity of the surf.



The Small Cruise Ship Collection

www.small-cruise-ships.com

01432 507 280 (within UK)

info@small-cruise-ships.com | small-cruise-ships.com



The Small Cruise Ship Collection

www.small-cruise-ships.com

small-cruise-ships.com

info@small-cruise-ships.com

DAY 8 – THURSDAY AM: PUNTA CORMORANT, FLOREANA PM: POST OFFICE BAY & BARONESS LOOKOUT, FLOREANA

AM: PUNTA CORMORANT, FLOREANA This site offers probably the best Flamingo lagoon in the Galapagos; it is also one of the largest in the islands. It's situated between two tuff lava cones that give the area a special atmosphere. There are various species of shorebirds to observe besides flamingos; the most frequent are common stilts, white-checked pintail ducks as well as other migratory birds. It is very interesting to see the two distinct beaches: "The Green Beach" (due to its high percentage of olivine crystals in the sand) and the "Flour Sand Beach" which is made up of coral. PM: POST OFFICE BAY & BARONESS LOOKOUT, FLOREANA Historically, this site is the location of a wooden barrel that was placed in the 18th century by the crew of a whaling ship. It has been used since this time by mariners and tourists as a post office. The idea is to carry letters or postcards to their destination by hand. Apart from being the Post Office Barrel, this site was the landing area for some of the first colonists. We will continue to the north of the island and will visit the Baroness Bay, here we will have the opportunity to Kayak and explore the inlets where seabird nesting sites and sea lion colonies can be found. It is said that Baroness Eloisa von Wagner loved this place and spent several hours watching the horizon. It is a beautiful bay that allows to breathe in the coastal and volcanic scenery. You will enjoy amazing views from the Sea Star sundeck covering the scenery from Enderby islet to Post office bay, Cerro Pajas, the pool of flamingos and wide forest of Palo Santo.

DAY 9 – FRIDAY AM: SANTA FE PM: PLAZAS

AM: SANTA FE In the southeastern part of the Galapagos, is Santa Fe. This island was formed from an uplift instead than a volcanic origin, this is why is mostly flat. There are some theories

which assure this could be the oldest island in the Archipelago. Santa Fe is the home of a number of endemic species like the Galapagos Hawk, Galapagos snake, Galapagos mockingbird, rice rats and one of the two species of lands Iguanas of the islands. After disembarkation in the beautiful and clear waters you will be in contact with one of the many sea lion colonies. Along the trail, you can see many salt bushes as well giant Pickly pear cactus, gigantism is a characteristic of oceanic islands. There are great possibilities of snorkeling with playful sea lions and tropical fishes. PM: PLAZAS At the east of Santa Cruz, is Plazas. Despite its small size, you can find here some of the most interesting and outstanding species of the Galapagos. In fact, the Plazas land iguanas are smaller than its relatives found at other islands. Throughout the island there are several hybrid iguanas. For example, a crossing of male marine iguana and a female land iguana, they are unique. As a result, they are recognizable at first glance by their black/gray color, with a land iguana's crest, but face and tail of the marine iguana. The big population of iguanas is due to the presence of tunas, their favorite food. Swallow Tailed Gulls nesting in the rugged cliffs are seen along with other sea birds as: Audubon shearwaters, red-billed tropicbirds, frigate birds and brown pelicans.

DAY 10 – SATURDAY AM: NORTH SEYMOUR ISLAND PM: BACHAS BEACH, SANTA CRUZ ISLAND

AM: NORTH SEYMOUR ISLAND Seymour is an uplifted (as opposed to volcanic) island and so is generally flat and strewn with boulders. There are good nesting sites here for a large population of magnificent frigate birds. Blue-footed boobies perform their courtship dance in the more open areas and swallow-tailed gulls perch on the cliff edges. Despite the tremendous surf that can pound the outer shore, sea lions haul out onto the beach and you can see them surfing. Watch your



step, as the boobies don't worry much about where they nest, and you might just step on one. In fact, the trees have many male frigate birds trying to attract the attention of the ladies by inflating their bright red skin flaps. They sometimes fly in the air to call more attention to themselves. There's a circular path that takes you through the island to a beautiful, rocky shore where the waves crash a silvery-blue. PM: BACHAS BEACH, SANTA CRUZ ISLAND These two small are in the West of Turtle Cove. Their sand is made of decomposed coral, which makes it white and soft, therefore, it is a good place for the sea turtles nesting site. Behind one of the beaches, there is a small brackish water lagoon. Here is possible to observe flamingos and other coastal birds, such as black-necked stilts and whimbrels. The other beach is longer, and you can see there two old Second World War barges when the USA used Baltra Island as a strategically point to protect the Panama Channel.

DAY 11 – SUNDAY AM: MOSQUERA ISLET

AM: MOSQUERA ISLET The location of Mosquera Islet is between Baltra and North Seymour Islands. A geological uplift formed this islet, in its narrowest width reaches 160 meters approximately. This islet has one of the largest populations of sea lions, visitors can also observe several species of shorebirds. Thus, if you are lucky you can see dolphins and orcas around this islet. After this activity, you will go to the Baltra airport for your flight back to the mainland.

Please Note:

Itineraries are subject to change.



The Small Cruise
Ship Collection

www.small-cruise-ships.com



small-cruise-ships.com

info@small-cruise-ships.com

YOUR SHIP: GALAPAGOS SEA STAR

YOUR SHIP: Galapagos Sea Star

VESSEL TYPE:

LENGTH:

PASSENGER CAPACITY:

BUILT/REFURBISHED:

Galapagos Sea Star The Galapagos Sea Star has a maximum capacity of 16 passengers, featuring seven spacious Galapagos Suites (approx. 25,2 m) and one Sea Star Suite (approx. 35,2 m) equipped with panoramic windows to enjoy the wonderful landscapes of the islands. All suites have a private bathroom, hot/cold water and air conditioning (with independent controls). Twin beds (or one faux queen bed) and connected suites are available for families. Local and International dishes – especially designed by our chef – are served in the cozy atmosphere of our dining room. Our yacht offers a large solarium with shaded and uncovered areas, two Jacuzzis and comfortable sun loungers. Social areas include a Saloon, mini-library and video library as well as a play zone for kids (during family departures). Snorkeling equipment and kayaks are available too without any extra charge. Galapagos Sea Star complies with local and international safety regulations. In addition, we implement sustainable practices throughout our journey to protect the fragile environment of the Galapagos archipelago. All guests will enjoy the well-furnished areas offering comfort and privacy. Galapagos Seaman has a maximum capacity of 16 passengers allowing both intimacy and camaraderie at the same time. There

are several resting areas for those who are looking for a quiet place to relax during their Galapagos trip with family and friends in the lazy mid-afternoon sun, or likewise after a busy day of swimming, snorkeling, kayaking, or walking on one of the Galapagos Islands. To check out the gorgeous ocean views with fellow shipmates, guests can spend some time on the spacious sundecks. Whether you feel like getting a little sun or want the best place to enjoy the gorgeous sunsets over the Galapagos Islands, the sundecks are the best place to be. For the adults who might want to relax and kick back, there is a great bar



and lounge.

The Small Cruise
Ship Collection

www.small-cruise-ships.com

01432 507 280 (within UK)

info@small-cruise-ships.com | small-cruise-ships.com



The Small Cruise Ship Collection

www.small-cruise-ships.com



small-cruise-ships.com

info@small-cruise-ships.com

INSIDE YOUR SHIP



Upper Deck



Sun deck

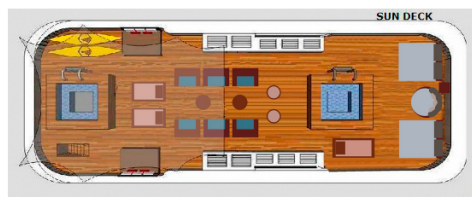

The Small Cruise Ship Collection

www.small-cruise-ships.com

01432 507 280 (within UK)

info@small-cruise-ships.com | small-cruise-ships.com



The Small Cruise
Ship Collection

www.small-cruise-ships.com



small-cruise-ships.com

info@small-cruise-ships.com

PRICING

ADDITIONAL CHARGES:

Galapagos National Park & Transit

Control Card 120 USD pp



The Small Cruise
Ship Collection

www.small-cruise-ships.com

01432 507 280 (within UK)

info@small-cruise-ships.com | small-cruise-ships.com