

The Small Cruise Ship Collection

www.small-cruise-ships.com

small-cruise-ships.com

info@small-cruise-ships.com

DUBROVNIK AND THE ADRIATIC (PRINCESS ALOHA)

A classic cruise from Dubrovnik on a delightful small ship. We spend a little time in beautiful Dubrovnik before we set sail to historic Korcula, the birth place of Marco Polo and an amazing old fortified port town. Pucisca is one of the prettiest villages on the Adriatic, being home to a stonemasons school. Split is an amazing city, with most of the centre being built into the remains of Diocletian's Palace, which is now a thriving hub of cafes, restaurants, apartments, museums and houses. We will also stop at Hvar, known as Croatia's jetset island, and the beautiful Mljet National Park. The evenings we are free to try the many restaurants, cafes and bars that nestle around the ports we are moored in.



ITINERARY

Day 1 DUBROVNIK Sunday

We embark in Dubrovnik at 13:00h, get settled in your cabin before attending a Welcome reception followed by dinner this evening.

Day 2 DUBROVNIK – KORČULA Monday

Early in the morning we set sail for the island of Korčula, with swimming stop, if weather permits, in one of pristine bays, time to relax and lunch onboard. Continue towards Korčula, the most preserved medieval town, thought to be the birthplace of the famous explorer Marco Polo. We will spend the night here. Take a walking tour of Korčula which takes you through its narrow,

The Small Cruise Ship Collection
www.small-cruise-ships.com

01432 507 280 (within UK)

info@small-cruise-ships.com | small-cruise-ships.com



The Small Cruise Ship Collection

www.small-cruise-ships.com

small-cruise-ships.com

info@small-cruise-ships.com

cobbled streets full of history. Evening is free to explore the town on your own.

Day 3 KORCULA - PUCISCA Tuesday

Our journey then continues towards Pu i š a, situated on the island of Bra , village of the stone sculpture, where you can visit amazing stonemason school (optional). Lunch on board before arrival in Pu i š a, enjoy a swim in one of Bra 's many lovely coves and bays, if weather permits. Enjoy Captain's dinner onboard and overnight in Pu i š a.

Day 4 PUCISCA - OMIS - SPLIT Wednesday

We depart for Omiš before breakfast, its fortresses are silent stone reminders of the power of the pirates who once made their homes and fortunes here. You will have a possibility to book a short walking tour, followed by boarding a small boat and sail into Cetina River Canyon, a protected nature area, continuing to Radman Mills for a local specialty snack. After visiting Omiš set sail to Split with a stop along the way to swim and relax, if weather permits, with lunch on board. In the late afternoon we arrive at Split to spend the night. Arriving in Split, join a guided tour of the city, visit the seafront promenade and Roman Emperor Diocletian's Palace. The historical center of the city is listed as a UNESCO World Heritage site. Your evening is free in Split.

Day 5 SPLIT - STARI GRAD Thursday

Morning sail towards Stari Grad, swimming stop and lunch on board. Stari Grad is one of the oldest towns in Europe with many friendly and cheap konobas and restaurants in the backstreets of the old town. The Stari Grad Plain and the old town centre of Stari Grad have been listed as UNESCO World Heritage Sites since 2008. Your evening is free to explore Stari Grad on your own.

Day 6 STARI GRAD - HVAR - MLJET Friday

Departing from Stari Grad in the morning, we sail to Hvar for a sightseeing tour. Hvar town shows you the first public theatre in Europe (older than Shakespeare's theatre in the UK) and many more historical sites. Afterwards come back for lunch on board and sail towards Mljet. Croatian "Greenest Island" will hypnotize you with its beautiful, untouched nature and its cultural heritage. We arrive in the heart of Mljet National Park which encompasses five types of forests, many species of birds and two deep lakes. If you want to visit Mljet National Park, walk to the entrance where you can purchase the ticket to walk around the Veliko Jezero (Big Lake) and the Malo Jezero (Small Lake) and join the boat ride to St. Mary Island. Spend the night in Mljet.

Day 7 MLJET - DUBROVNIK Saturday

In the morning we continue our adventure by sailing back to Dubrovnik with lunch on board with stop for swimming. Upon arrival in Dubrovnik, you will enjoy a guided tour of the magnificent Old Town with a panoramic bus ride above the Old Town. After the panoramic view, we will arrive at the historical

The Small Cruise
Ship Collection
www.small-cruise-ships.com

01432 507 280 (within UK)

info@small-cruise-ships.com | small-cruise-ships.com



centre of Dubrovnik, walk through STRADUN - both a street and a square, the most famous place inside the town walls, the famous city enlisted as UNESCO's World Heritage site, where your guide will show you the most interesting sights of Dubrovnik. After city tour, you will be left on your own to explore the city, visit City Walls, the Franciscan Monastery with Europe's second oldest pharmacy, the Rector's Palace and the Cathedral, take a boat ride to Lokrum island or take the cable car to the top of the Mount Sr . Overnight in Dubrovnik.

Day 8 DUBROVNIK DEPARTURE Sunday

Disembark after breakfast.

Please note:

Itineraries are subject to change

The Small Cruise Ship Collection

www.small-cruise-ships.com

small-cruise-ships.com

info@small-cruise-ships.com

YOUR SHIP: ALOHA

YOUR SHIP:

Aloha

VESSEL TYPE:

LENGTH:

PASSENGER CAPACITY:

BUILT/REFURBISHED:



M/S Princess Aloha was built in 2013. Maximum capacity is 36 passengers in 16 twin or double beds cabins and 2 triple cabins. All cabins have been built by up-to-date standards, each, fully equipped with A/C, LCD TV, safe deposit box, fire alarm, internal communication system between rooms. Bathrooms are equipped with toilet, shower, wash basin, also included is hair dryer and for added convenience cosmetic package. All cabins are sound-proof and each cabin comes with the fire-proof doors, guaranteeing privacy for all guests. The restaurant area is fully air-conditioned for passengers comfort. A portion of the dining area extends outdoors, offering sweeping panoramic views of the surroundings area and it can accommodate all passengers at once. The restaurant includes bar area with LCD TV, there is also a corner table for buffet breakfast. There is also free wireless internet access (Wi-Fi). The lounging sundeck has a total surface of 2,368 square feet, partially offering sun-shade cover and providing deck-beds for all passengers. The ship has a rear access platform to the sea as well as ladders for easy access to the water. In addition, the vessel offers two outdoor showers and four deck lavatories. Electricity on board: 220V.

The Small Cruise
Ship Collection
www.small-cruise-ships.com

01432 507 280 (within UK)

info@small-cruise-ships.com | small-cruise-ships.com

The Small Cruise Ship Collection

www.small-cruise-ships.com

small-cruise-ships.com

info@small-cruise-ships.com

INSIDE YOUR SHIP

Princess Aloha Deckplan

UPPER DECK

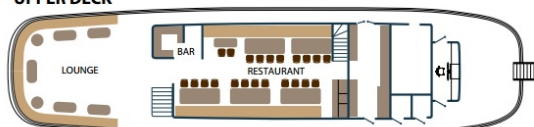

MAIN DECK



LOWER DECK

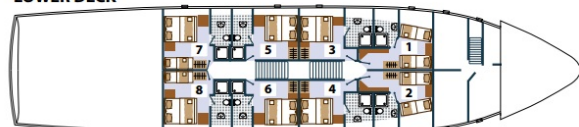



The Small Cruise
Ship Collection

www.small-cruise-ships.com

small-cruise-ships.com

info@small-cruise-ships.com

PRICING

ADDITIONAL CHARGES:

Port taxes and tourist tax 35 EUR
pp



The Small Cruise
Ship Collection

www.small-cruise-ships.com

01432 507 280 (within UK)

info@small-cruise-ships.com | small-cruise-ships.com