

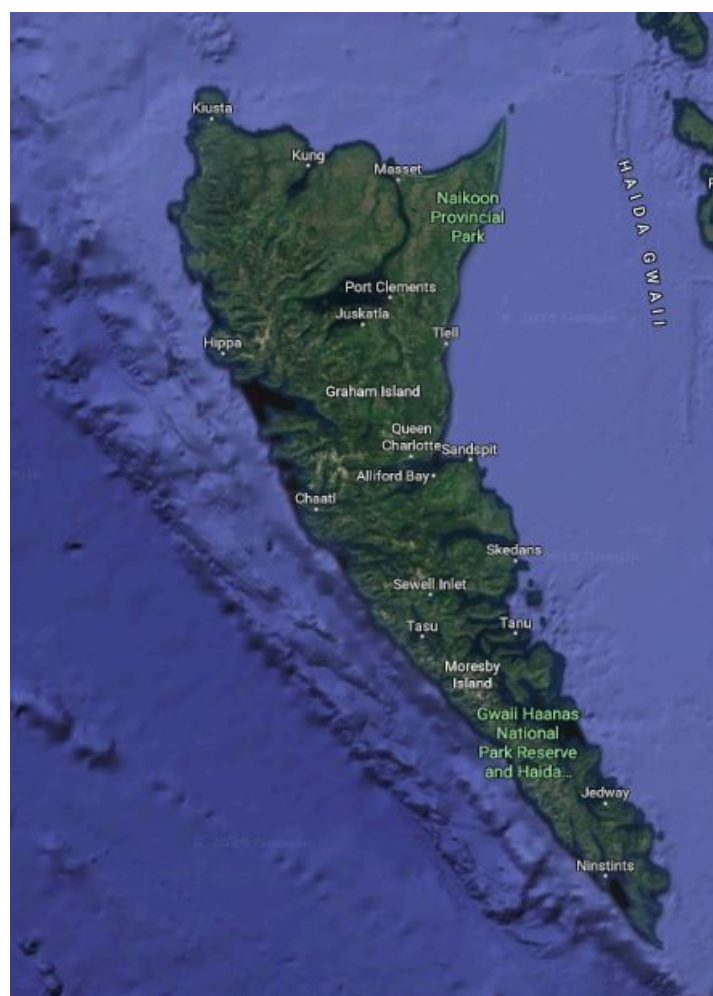

HAIDA GWAI- CATAMARAN

Haida Gwaii, formerly the Queen Charlotte Islands, is an archipelago of islands on the continental shelf off Canada's west coast. Join us for an 8-day adventure by land and sea. You'll explore the famed, rich marine life and rainforests, as well as the Haida culture. Includes the whole archipelago, from north to south, ancient to modern, including Gwaii Haanas and UNESCO World Heritage Site SGang Gwaay (Ninstints).



ITINERARY

Day 1



The Small Cruise Ship Collection

www.small-cruise-ships.com



small-cruise-ships.com

info@small-cruise-ships.com

Day 6

Sailing Juan Perez Sound, whale watching, visit seabird researchers at seabird colony.

Day 7

Windy Bay cultural heritage site, whale watching, K'uuna (Skedans) village site.

Day 8

Cruising to Moresby Camp in Cumshewa Inlet and transfer to Sandspit airport.

Meet at Vancouver airport for flight to Haida Gwaii. Tour kickoff, land-based tour of Graham Island. Welcome dinner and lodge accommodation.

Day 2

Tlell, Skidegate, Haida Heritage Centre at KAAY LLNAGAAY, board ship, orientation, cruising into the southern half of the Haida Gwaii tour - Gwaii Haanas, whale watching, island anchorage and explore ashore.

Day 3

Head south to Gwaii Haanas National Park Reserve, National Marine Conservation Area Reserve and Haida Heritage Site. T'aanuu village site, Burnaby Narrows for some of the planet's densest intertidal life, kayaking, cruising.

Day 4

Seabirds viewing, UNESCO World Heritage Site visit, SGang Gwaay (Ninstints), offshore islets, Rose Harbour visit (remote community, pop. 4).

Day 5

Cruising, rainforest walk, possible bears.



The Small Cruise Ship Collection

www.small-cruise-ships.com

01432 507 280 (within UK)

info@small-cruise-ships.com | small-cruise-ships.com



The Small Cruise Ship Collection

www.small-cruise-ships.com

small-cruise-ships.com

info@small-cruise-ships.com

YOUR SHIP: CASCADIA

YOUR SHIP: Cascadia

VESSEL TYPE:

LENGTH:

PASSENGER CAPACITY:

BUILT/REFURBISHED:

Cascadia is a go-anywhere, expedition style catamaran. She accommodates up to 24 guests in 12 luxurious cabins, with a crew of 10. She is unlike any other vessel offering expeditions on the British Columbia coast, having been built specifically for high-quality, boutique cruises. Light, spacious and comfortable, she is also capable of reaching the wildest, most naturally rich places on the coast. Her small size and guest numbers provide an authentic, human-scale experience that respects the carrying capacity of coastal inlets and communities. Ship And Accommodations Find comfort and solitude in your private cabin or enjoy time in any of the interior or outdoor lounges, or the "open" bridge. Cascadia's large windows bring the outside in, and her separate dining area becomes a sophisticated "long table" event for meals. Her decks are wide and welcoming, with seating areas on different levels. Salon Large windows surround the salon making it a perfect place to look for whales while staying protected, chat with other guests while lounging on our comfortable sofas, or enjoy a beverage from the nearby bar. Dining Area Enjoy our chefs' fine west-coast influenced creations while watching the sun go down. Sit and discuss your day's adventure with your captain, afloat in a remote natural

anchorage. Terrace Lounge And Dining Area Dine alfresco on temperate evenings, lounge with your morning coffee, or watch the world go by during the day. This area is the perfect mix of outside and inside. Bridge of Cascadia Cascadia's bridge is open to you. You'll have 180-degree views from here, along with being able to learn about navigation and the vessel systems from our crew. On the port side, you may also enjoy our indoor-outdoor loveseat. You can watch the world go by from behind a protective window, but still have quick access to the fresh air and the deck for whale watching. Top Deck & Hot Tub Lounge on a chaise, soak under the stars, or enjoy the bird's eye view of the ship and the world around her from Cascadia's new top deck. Cabins All cabins have individual climate control, wardrobes and an outside location, with windows for natural light. All have ensuite. All are 'outside' cabins, with windows for natural light. Kayaks, Shore Boats, Naturalist Tools Cascadia has 6 double and 2 single kayaks for paddling in coves and bays, as well as two beautiful landing craft style tenders, custom designed for our program. She carries a suite of tools for exploring the natural world, including a hydrophone for listening to whales. Her library contains books on the cultural history and nature of the BC and

The Small Cruise Ship Collection
www.small-cruise-ships.com

01432 507 280 (within UK)

info@small-cruise-ships.com | small-cruise-ships.com



Alaska coast.



The Small Cruise Ship Collection

www.small-cruise-ships.com



small-cruise-ships.com

info@small-cruise-ships.com

INSIDE YOUR SHIP

TOP DECK

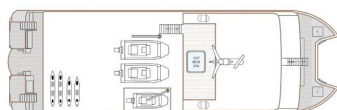

BRIDGE DECK

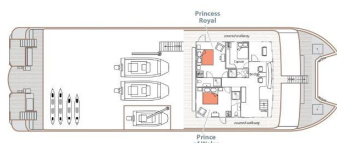

MAIN DECK



LOWER DECK



The Small Cruise Ship Collection

www.small-cruise-ships.com

01432 507 280 (within UK)

info@small-cruise-ships.com | small-cruise-ships.com



The Small Cruise
Ship Collection

www.small-cruise-ships.com



small-cruise-ships.com

info@small-cruise-ships.com

PRICING

ADDITIONAL CHARGES:

Sustainability Fee 80 USD pp



The Small Cruise
Ship Collection

www.small-cruise-ships.com

01432 507 280 (within UK)

info@small-cruise-ships.com | small-cruise-ships.com