

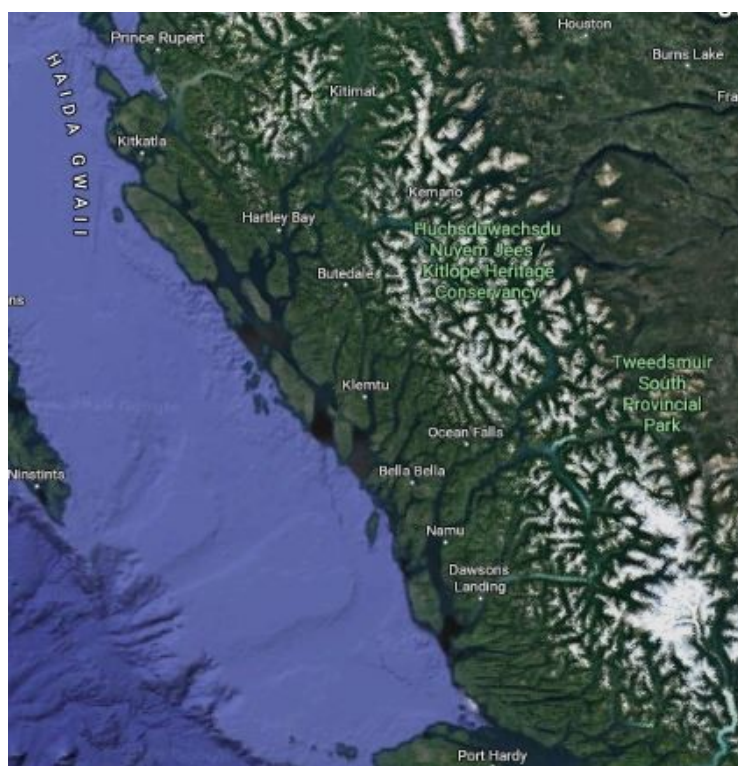

## GREAT BEAR RAINFOREST- CATAMARAN

The Great Bear Rainforest is a land of fjords, islands and great river estuaries. It's world's largest intact temperate rainforest. Bears and wolf packs thrive as they have for millennia. Explore the wildlife, the waterfall-filled wonder, and the human history of one of earth's most spectacular coastlines - "the last stand of the great North American rainforest," according to Robert F. Kennedy, Jr. This trip is during the salmon run, when bears and other wildlife are on the coast.



### ITINERARY

#### Day 1

Welcome aboard in Haisla territory, cruising to evening anchorage, watching for whales. Evening rainforest walk before dinner.

#### Day 2



## The Small Cruise Ship Collection

[www.small-cruise-ships.com](http://www.small-cruise-ships.com)



[small-cruise-ships.com](http://small-cruise-ships.com)

[info@small-cruise-ships.com](mailto:info@small-cruise-ships.com)

### Day 6

Cruising down a spectacular, long fjord, where granite mountains rise from thousands of feet below in the sea. Viewing waterfalls and possible mountain goats. Exploring ashore in estuary meadows, where some bears spend their days in the autumn. Learning about the daily life of bears, and the salmon cycle. Optional evening kayaking.

Rainforest walk and salmon spawning stream. Cruising to historic cannery site of Butedale on Princess Royal Island. Optional hike to lake.

### Day 7

Visit island known as the epicentre of spirit bears with local guides as well as Cascadia's bear guides. Full day at viewing site for the best opportunity to view a spirit bear. Last night celebration dinner and events.

### Day 8

Cruising to Kitimat, watching for wildlife.

Please note:

Itineraries are subject to change.

### Day 3

Bear viewing among the fjords. Learning the indigenous history and stories of special sites in the region. Cruising the Great Bear's island channels. Visit to village of Hartley Bay for a big house tour and cultural introduction by local guide.

### Day 4

Cruising Whale Channel region, a critical habitat for several species of whales. Whale viewing. Visit whale researchers at remote station. Sea lion viewing. Island anchorage.

### Day 5

Visit the Great Bear Rainforest's wild outer islands and beaches. Beach visit and hike to views over the Pacific ocean. Kayaking or optional fishing. Cruising to and exploring archipelago of tiny islands, some areas so wild they're not yet fully charted. Seabird viewing.



The Small Cruise Ship Collection

[www.small-cruise-ships.com](http://www.small-cruise-ships.com)

**01432 507 280** (within UK)

[info@small-cruise-ships.com](mailto:info@small-cruise-ships.com) | [small-cruise-ships.com](http://small-cruise-ships.com)





## The Small Cruise Ship Collection

[www.small-cruise-ships.com](http://www.small-cruise-ships.com)

[small-cruise-ships.com](http://small-cruise-ships.com)

[info@small-cruise-ships.com](mailto:info@small-cruise-ships.com)

## YOUR SHIP: CASCADIA

**YOUR SHIP:** Cascadia

**VESSEL TYPE:**

**LENGTH:**

**PASSENGER CAPACITY:**

**BUILT/REFURBISHED:**

Cascadia is a go-anywhere, expedition style catamaran. She accommodates up to 24 guests in 12 luxurious cabins, with a crew of 10. She is unlike any other vessel offering expeditions on the British Columbia coast, having been built specifically for high-quality, boutique cruises. Light, spacious and comfortable, she is also capable of reaching the wildest, most naturally rich places on the coast. Her small size and guest numbers provide an authentic, human-scale experience that respects the carrying capacity of coastal inlets and communities. Ship And Accommodations Find comfort and solitude in your private cabin or enjoy time in any of the interior or outdoor lounges, or the "open" bridge. Cascadia's large windows bring the outside in, and her separate dining area becomes a sophisticated "long table" event for meals. Her decks are wide and welcoming, with seating areas on different levels. Salon Large windows surround the salon making it a perfect place to look for whales while staying protected, chat with other guests while lounging on our comfortable sofas, or enjoy a beverage from the nearby bar. Dining Area Enjoy our chefs' fine west-coast influenced creations while watching the sun go down. Sit and discuss your day's adventure with your captain, afloat in a remote natural

anchorage. Terrace Lounge And Dining Area Dine alfresco on temperate evenings, lounge with your morning coffee, or watch the world go by during the day. This area is the perfect mix of outside and inside. Bridge of Cascadia Cascadia's bridge is open to you. You'll have 180-degree views from here, along with being able to learn about navigation and the vessel systems from our crew. On the port side, you may also enjoy our indoor-outdoor loveseat. You can watch the world go by from behind a protective window, but still have quick access to the fresh air and the deck for whale watching. Top Deck & Hot Tub Lounge on a chaise, soak under the stars, or enjoy the bird's eye view of the ship and the world around her from Cascadia's new top deck. Cabins All cabins have individual climate control, wardrobes and an outside location, with windows for natural light. All have ensuite. All are 'outside' cabins, with windows for natural light. Kayaks, Shore Boats, Naturalist Tools Cascadia has 6 double and 2 single kayaks for paddling in coves and bays, as well as two beautiful landing craft style tenders, custom designed for our program. She carries a suite of tools for exploring the natural world, including a hydrophone for listening to whales. Her library contains books on the cultural history and nature of the BC and



The Small Cruise Ship Collection  
[www.small-cruise-ships.com](http://www.small-cruise-ships.com)

**01432 507 280** (within UK)

[info@small-cruise-ships.com](mailto:info@small-cruise-ships.com) | [small-cruise-ships.com](http://small-cruise-ships.com)



Alaska coast.





# The Small Cruise Ship Collection

[www.small-cruise-ships.com](http://www.small-cruise-ships.com)



[small-cruise-ships.com](http://small-cruise-ships.com)

[info@small-cruise-ships.com](mailto:info@small-cruise-ships.com)

## INSIDE YOUR SHIP

TOP DECK

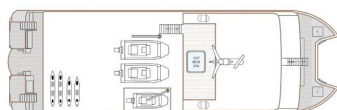

BRIDGE DECK

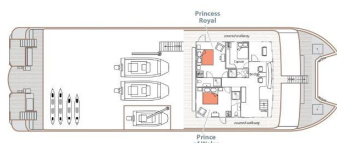

MAIN DECK



LOWER DECK



The Small Cruise Ship Collection

[www.small-cruise-ships.com](http://www.small-cruise-ships.com)

01432 507 280 (within UK)

[info@small-cruise-ships.com](mailto:info@small-cruise-ships.com) | [small-cruise-ships.com](http://small-cruise-ships.com)



The Small Cruise  
Ship Collection

[www.small-cruise-ships.com](http://www.small-cruise-ships.com)



[small-cruise-ships.com](http://small-cruise-ships.com)

[info@small-cruise-ships.com](mailto:info@small-cruise-ships.com)

## PRICING

---

### ADDITIONAL CHARGES:

Sustainability Fee 80 USD pp



The Small Cruise  
Ship Collection

[www.small-cruise-ships.com](http://www.small-cruise-ships.com)

**01432 507 280** (within UK)

[info@small-cruise-ships.com](mailto:info@small-cruise-ships.com) | [small-cruise-ships.com](http://small-cruise-ships.com)