

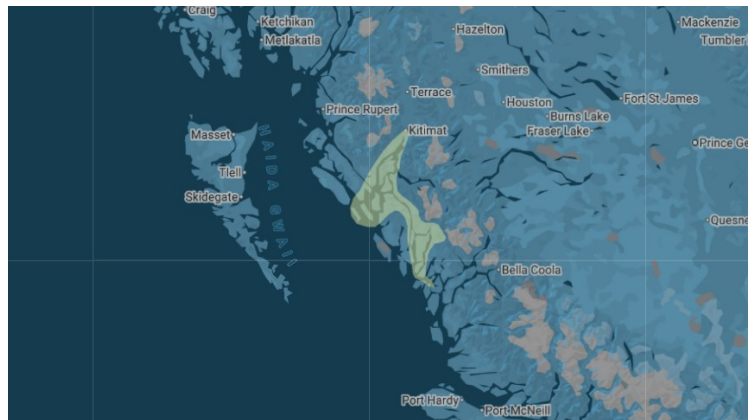

GREAT BEAR RAINFOREST CANADA CRUISE

Experience the 'Amazon of the North' A jaw dropping display of rugged wilderness As much of the Great Bear Rainforest is only accessible via floatplane, travelling by boat is the most in depth and extensive way to adventure this part of the coast. Wildlife and heart stopping landscapes abound, feeding bears is just the tip of the experiences iceberg.



ITINERARY

Trip Start - Day 1 Into the Heart of the Rainforest

Bluewater Adventures offers three different route options for this itinerary. Please check your trip's dates to confirm your start/end location.

Prior to your trip start, fly into Terrace. Pick up on the morning of Day 1 will be at select hotels (refer to your Itinerary Package for further details). The shuttle will transfer guests from Terrace to Kitimat where you will meet your Bluewater Adventures crew & vessel. Following boarding, we'll depart into a land of dense forests reaching to the water's edge, towering rocky fjords, and lush valley estuaries.

Days 2-4 Winding Waterways & Wonderful Wildlife

As we explore the waters of southern Douglas Channel and at various other places along our journey, we expect to encounter humpback whales. We'll take the time to observe these



The Small Cruise Ship Collection

www.small-cruise-ships.com

small-cruise-ships.com

info@small-cruise-ships.com

15-metre-long creatures whenever the opportunity arises and hope to witness spectacular behaviours like breaches, pectoral slaps, and possibly bubble-net feeding (an amazing cooperative foraging technique). We also hope to have luck in spotting other marine mammals like fin whales, orca, porpoise, and Steller sea lions. Time allowing, we may visit local whale researchers to learn about their fascinating work.

There may be an opportunity to visit Bishop Bay hot springs for a soothing soak amidst an eclectic collection of fishing floats.

Days 5-7 The "Salmon Forest"

As we travel along Princess Royal Island, we keep a close watch on the shoreline, since this is the best-known area for seeing the elusive, all-white Spirit bear (also known as Kermode bear). These white bears are black bears expressing a genetic variation resulting in light coloured fur. We are fortunate to spend a day with local Gitga'at First Nation guides who will take us to their favourite bear viewing areas. With a little patience, we hope to be lucky enough to see black bears and the Spirit bear fishing for salmon at quiet spawning streams hidden in the thick of the forest.

This unique coastal ecosystem supports impressive biodiversity - from salmon and marine mammals in the sea, to bears, coastal wolves, birds, and massive trees on land. We expect some good grizzly viewing at the water's edge when visiting lush estuaries in the beautiful river valley of Khutze Inlet (K'ootz/Khutze Conservancy) and Fiordland Conservancy with its rocky cliff faces.

Trip Finish - Day 8 Heading Home

Our trip finishes in the small First Nations coastal town of Bella Bella - also known as Waglisla - which is the home of the Heiltsuk First Nation. We will arrive at the Bella Bella Municipal Dock just before noon in time to catch the afternoon flight back to Vancouver. Guests can also explore the area further on their own - nearby Shearwater is a short seabus ride away and offers the most amenities for visitors.

Bluewater Adventures offers three different route options for this itinerary. Please check your trip's dates to confirm your start/end location.

Please note:

We keep our itineraries purposefully flexible allowing our captains to cater to the needs and interests of their group as well as take into account weather, wildlife sightings, and more.

The Small Cruise Ship Collection

www.small-cruise-ships.com

01432 507 280 (within UK)

info@small-cruise-ships.com | small-cruise-ships.com



The Small Cruise Ship Collection

www.small-cruise-ships.com



small-cruise-ships.com

info@small-cruise-ships.com

YOUR SHIP: ISLAND ODYSSEY

| | |
|----------------------------|----------------|
| YOUR SHIP: | Island Odyssey |
| VESSEL TYPE: | Yacht |
| LENGTH: | 21 metres |
| PASSENGER CAPACITY: | 16 |
| BUILT/REFURBISHED: | 1984 / 2003 |



Joining us in 2003, this 68' ketch, The Island Odyssey is the sister-ship to 'Island Roamer'. Originally built as a luxurious private yacht in 1984, she completed a major renovation in 2003 to update the cabins and all safety systems. She features 8 private cabins (double occupancy), 3 heads with hot showers and a comfortable salon with a natural history library. On deck, the large deckhouse provides a comfortable spot to watch for wildlife. A certified Canadian Ministry of Transport passenger vessel, Island Odyssey has all of the safety equipment, electronic navigation aids, and features you would expect from a vessel of her standard. All of our cabins have adequate storage space for your bags, personal items and jackets. Coat hangers and life jackets are stowed in every cabin for your convenience. There is electricity in each room, so you can charge your camera batteries and enjoy a reading light in the evening.



The Small Cruise Ship Collection

www.small-cruise-ships.com

01432 507 280 (within UK)

info@small-cruise-ships.com | small-cruise-ships.com



The Small Cruise Ship Collection

www.small-cruise-ships.com



small-cruise-ships.com

info@small-cruise-ships.com

INSIDE YOUR SHIP

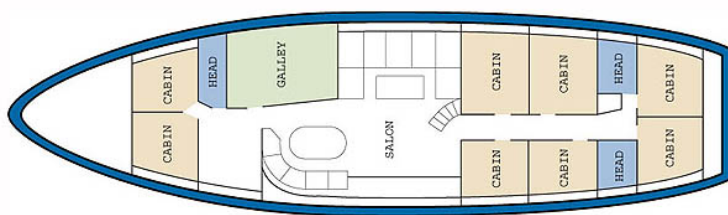

Cabin



The Small Cruise Ship Collection

www.small-cruise-ships.com

01432 507 280 (within UK)

info@small-cruise-ships.com | small-cruise-ships.com



The Small Cruise Ship Collection

www.small-cruise-ships.com



small-cruise-ships.com

info@small-cruise-ships.com

PRICING

25-Aug-2026 to 01-Sep-2026

| | |
|-------|--------------|
| Cabin | £6036 GBP pp |
|-------|--------------|

27-Aug-2026 to 03-Sep-2026

| | |
|-------|--------------|
| Cabin | £4828 GBP pp |
|-------|--------------|

28-Aug-2026 to 04-Sep-2026

| | |
|-------|--------------|
| Cabin | £4828 GBP pp |
|-------|--------------|

02-Sep-2026 to 09-Sep-2026

| | |
|-------|--------------|
| Cabin | £6036 GBP pp |
|-------|--------------|

04-Sep-2026 to 11-Sep-2026

| | |
|-------|--------------|
| Cabin | £4828 GBP pp |
|-------|--------------|

05-Sep-2026 to 12-Sep-2026

| | |
|-------|--------------|
| Cabin | £4828 GBP pp |
|-------|--------------|

10-Sep-2026 to 17-Sep-2026

| | |
|-------|--------------|
| Cabin | £6036 GBP pp |
|-------|--------------|

12-Sep-2026 to 19-Sep-2026

| | |
|-------|--------------|
| Cabin | £4828 GBP pp |
|-------|--------------|

14-Sep-2026 to 21-Sep-2026

| | |
|-------|--------------|
| Cabin | £4828 GBP pp |
|-------|--------------|

18-Sep-2026 to 25-Sep-2026

| | |
|-------|--------------|
| Cabin | £6036 GBP pp |
|-------|--------------|

20-Sep-2026 to 27-Sep-2026

| | |
|-------|--------------|
| Cabin | £4828 GBP pp |
|-------|--------------|

26-Sep-2026 to 03-Oct-2026

| | |
|-------|--------------|
| Cabin | £6036 GBP pp |
|-------|--------------|

28-Sep-2026 to 05-Oct-2026

| | |
|-------|--------------|
| Cabin | £4828 GBP pp |
|-------|--------------|

04-Oct-2026 to 11-Oct-2026

| | |
|-------|--------------|
| Cabin | £6036 GBP pp |
|-------|--------------|

06-Oct-2026 to 13-Oct-2026

| | |
|-------|--------------|
| Cabin | £4828 GBP pp |
|-------|--------------|

ADDITIONAL CHARGES:

5% Canadian Tax + Sustainability
Fee 200 USD pp



The Small Cruise Ship Collection

www.small-cruise-ships.com

01432 507 280 (within UK)

info@small-cruise-ships.com | small-cruise-ships.com