

The Small Cruise Ship Collection

www.small-cruise-ships.com

small-cruise-ships.com

info@small-cruise-ships.com

ENTICING DOURO

Rambling vineyards and charming native farms cling to the steep sides of the Douro River Valley, creating an incomparable backdrop to one of Europe's most unspoiled regions and to Port country—the world's oldest demarcated wine region. Sail roundtrip from Porto, the beautiful “City of Bridges”; visit Regua, the ‘capital’ of the Douro Valley; and marvel at Salamanca, the UNESCO-designated “Golden City.” Taste wines from historic wineries and soak up the genuine beauty of one of Europe's most unadulterated landscapes.



ITINERARY

DAY 1: EMBARKATION – PORTO, PORTUGAL

Board the ship for your Enticing Douro cruise. (D)

DAY 2: ENTRE-OS-RIOS

Entre-os-Rios translates to “between the rivers,” and this small village is, quite appropriately, located at the confluence of the Tâmega and Douro rivers. This tranquil village offers an authentic slice of Douro River life. In the afternoon, indulge in a traditional Portuguese lunch with your fellow travelers in Entre-os-Rios at a local quinta – a country estate – for a truly authentic culinary experience. (B,L,D)

DAY 3: RÉGUA – PINHÃO



The Small Cruise Ship Collection

www.small-cruise-ships.com

small-cruise-ships.com

info@small-cruise-ships.com

Visit the Baroque-style Palacio de Mateus and its gardens. Inside the house, you'll see interesting furnishings, paintings and a ceiling of intricately carved wood. The gardens here are considered some of the most beautiful in Portugal. Later in the day, savor the flavors of Portugal's renowned fortified wine, vinho do porto, made exclusively in the Douro Valley. Head to a local quinta for your authentic Port-wine tasting experience and enjoy the sweet nectar of this fascinating region. (B,L,D)

DAY 4: VEGA DE TERRÓN, SPAIN – SALAMANCA

Drive to Salamanca, a UNESCO World Heritage Site. Built of golden sandstone, Salamanca is known as a "living museum," and you will have an opportunity to step back in time to the Middle Ages during your escorted tour, which includes the city's elegant university buildings, the New Cathedral, the intriguingly decorated House of Shells and Plaza Mayor. (B,L,D)

DAY 5: BARCA D'ALVA

Spend time soaking up the beauty of the Douro River as you cruise to Barca d'Alva, where you will visit Castelo Rodrigo, a small fortified village perched high on a hilltop with centuries-old walls, steep narrow streets and fantastic views. You can also opt to hike up to the village should you wish a more active exploration. While here, taste some delicious locally grown produce. Be treated to an exclusive dinner at Quinta da Avessada, where you'll enjoy an authentic and traditional dining experience complete with entertainment. Quinta da Avessada is also a fascinating interactive museum commemorating the history and culture of wine in the Alto Douro region, so you'll have fun discovering all the various stages of wine production as well as doing plenty of tasting. (B,L,D)

DAY 6: RÉGUA

Travel to picturesque Lamego, home to one of the most important pilgrimage sites in all of Portugal, where you'll go to the Nossa Senhora dos Remédios (Sanctuary of Our Lady of Remedies). The shrine features a staircase of nearly 700 steps, beautifully decorated with white and blue tiles, which the more active adventurer will want to climb on a guided hike. Concluding both tours, you will have the opportunity to sample local traditional specialties, such as bôlas de Lamego, bread filled with smoked ham; presunto, a type of dry-cured ham; and Espumante, a Portuguese sparkling wine. (B,L,D)

DAY 7: PORTO

The colorful city of Porto blends the best of old and new, which you can discover on an escorted tour of the historic quarter, a UNESCO World Heritage Site, including the Cathedral, one of the city's oldest monuments; and the São Bento Railway Station, known for its blue and white tile panels depicting scenes from Portuguese history. You'll also enjoy a tasting of Port, Portugal's most renowned contribution to the world of wine. If you prefer to get more active, you can go on a guided hike and then enjoy a Port wine tasting. Enjoy a free afternoon to explore all of Porto's charms on your own. (B,L,D)

DAY 8: PORTO – DISEMBARKATION

Disembark the ship and prepare for your flight home. (B)

The Small Cruise Ship Collection
www.small-cruise-ships.com

01432 507 280 (within UK)

info@small-cruise-ships.com | small-cruise-ships.com

The Small Cruise Ship Collection

www.small-cruise-ships.com

small-cruise-ships.com

info@small-cruise-ships.com

YOUR SHIP: AMADOURO

YOUR SHIP: AmaDouro

VESSEL TYPE:

LENGTH:

PASSENGER CAPACITY:

BUILT/REFURBISHED:

The AmaDouro features spacious, elegantly appointed staterooms, most of which include balconies to take in views of the breathtaking hills and terraced vineyards along the river. Staterooms also include Entertainment-On-Demand, featuring free high-speed Internet access, unlimited Wi-Fi, movies, music and English-language TV stations; climate-controlled air conditioning; and an in-room safe. The AmaDouro's Panoramic Lounge is a stylish and inviting space to enjoy a glass of wine or a cocktail along with our nightly entertainment. The ship also features a massage room, fitness room, sun-deck swimming pool and a gift shop, as well as the culinary delights of the Main Restaurant, where you'll be able to sample the region's famous Port wine.



The Small Cruise Ship Collection
www.small-cruise-ships.com

01432 507 280 (within UK)

info@small-cruise-ships.com | small-cruise-ships.com

INSIDE YOUR SHIP

AmaDouro DECK PLAN

- 1 Main Lounge
- 2 Reception
- 3 Elevator
- 4 Main Restaurant
- 5 Fitness Room
- 6 Spa

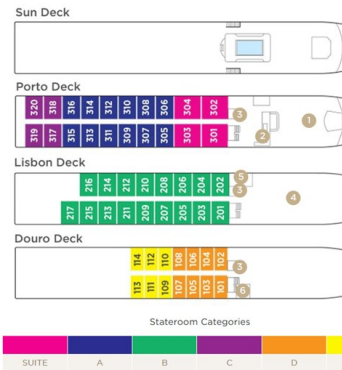

Category A Porto Deck 215 sq. ft. Category B Lisbon Deck 215 sq. ft.



Category C Porto Deck 161 sq. ft. Category D Douro Deck 161 sq. ft.

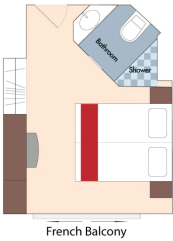

Category E Douro Deck 161 sq. ft. Suite Porto Deck, 323 sq. ft.

The Small Cruise Ship Collection

www.small-cruise-ships.com

small-cruise-ships.com

info@small-cruise-ships.com

PRICING

22-Jul-2025 to 29-Jul-2025

Category E Douro Deck 161 sq. ft.	£3562 GBP pp
Suite Porto Deck, 323 sq. ft.	£6638 GBP pp
Category C Porto Deck 161 sq. ft.	£4638 GBP pp
Category D Douro Deck 161 sq. ft.	£3792 GBP pp
Category B Lisbon Deck 215 sq. ft.	£5100 GBP pp
Category A Porto Deck 215 sq. ft.	£5330 GBP pp

29-Jul-2025 to 05-Aug-2025

Category A Porto Deck 215 sq. ft.	£5330 GBP pp
Category B Lisbon Deck 215 sq. ft.	£5100 GBP pp
Category D Douro Deck 161 sq. ft.	£3792 GBP pp
Category C Porto Deck 161 sq. ft.	£4638 GBP pp
Suite Porto Deck, 323 sq. ft.	£6638 GBP pp
Category E Douro Deck 161 sq. ft.	£3562 GBP pp

05-Aug-2025 to 12-Aug-2025

Category B Lisbon Deck 215 sq. ft.	£5100 GBP pp
Category D Douro Deck 161 sq. ft.	£3792 GBP pp
Category C Porto Deck 161 sq. ft.	£4638 GBP pp
Suite Porto Deck, 323 sq. ft.	£6638 GBP pp
Category E Douro Deck 161 sq. ft.	£3562 GBP pp
Category A Porto Deck 215 sq. ft.	£5330 GBP pp

12-Aug-2025 to 19-Aug-2025

Category E Douro Deck 161 sq. ft.	£3562 GBP pp
Suite Porto Deck, 323 sq. ft.	£6638 GBP pp
Category C Porto Deck 161 sq. ft.	£4638 GBP pp
Category D Douro Deck 161 sq. ft.	£3792 GBP pp
Category B Lisbon Deck 215 sq. ft.	£5100 GBP pp
Category A Porto Deck 215 sq. ft.	£5330 GBP pp